



Guidelines for Display Rules & Regulations

End-Cap Booth

An End-Cap Booth is exposed to aisles on three (3) sides and composed of a minimum of two (2) 10ft (3.05m) x 10ft (3.05m) booths.

Dimensions

End-Cap Booths are 20ft (6.09m) wide and a minimum of 10ft (3.05m) deep.

Use of Space

The maximum back wall height of 8ft (2.44m), including signage, is allowed only in the 10ft (3.05m) center portion of the booth. A maximum height of 4ft (1.22m) is allowed on the two (2) 5ft (1.52m) , permitting adequate line of sight for the adjoining In-line Booths.

Overhead Signs

Hanging overhead signs are not permitted for End-Cap Booths; nor may any signage, etc. extend beyond the 8ft (2.44m) height restriction in the center 10ft (3.05m) or above the 4ft (1.22m) height restriction on the two (2) 5ft (1.52m)

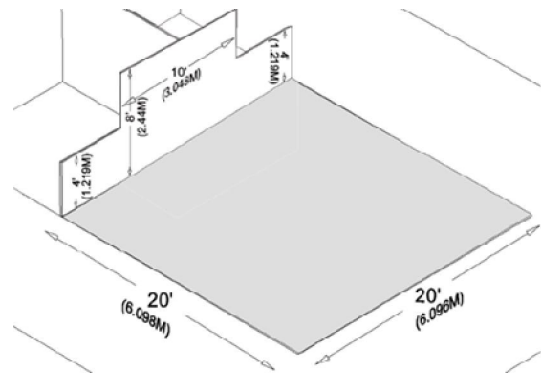
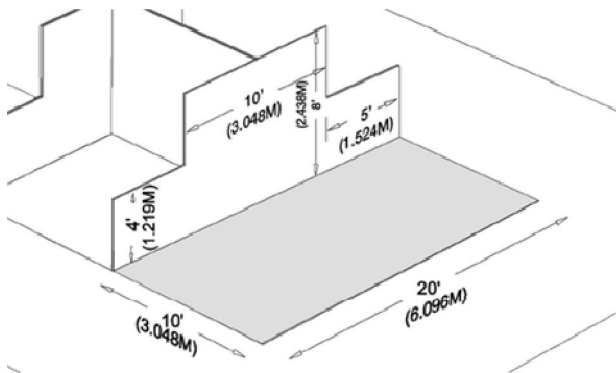

*For the ABC Kids Expo The back
On each 5ft (1.52m)

will consist of 10ft (3.05m) wide x 8ft (2.44m) tall pipe and drape.
(.91m) tall x 5ft (1.52m) wide pipe and drape.

*All Baby & Child, Corp. for use by and for events produced by this organization in all venues.
These regulations are based on guidelines developed by IAEE for use by its members.*